



TERMINAL USER GUIDE

Settlement

GHL MAH DA

Terminal Model: Nexgo N86

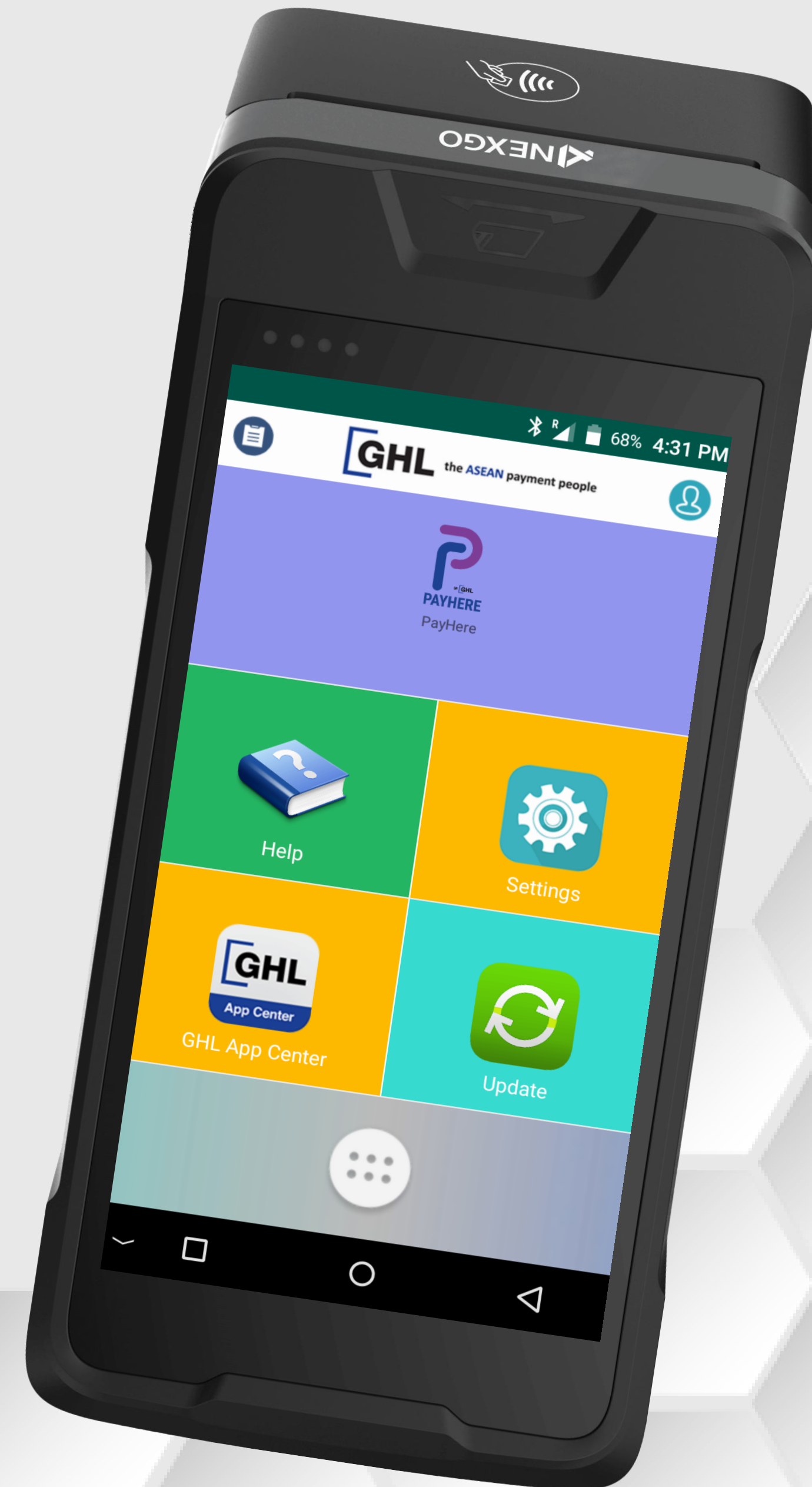

Settlement

Terminal Model: Nexgo N86

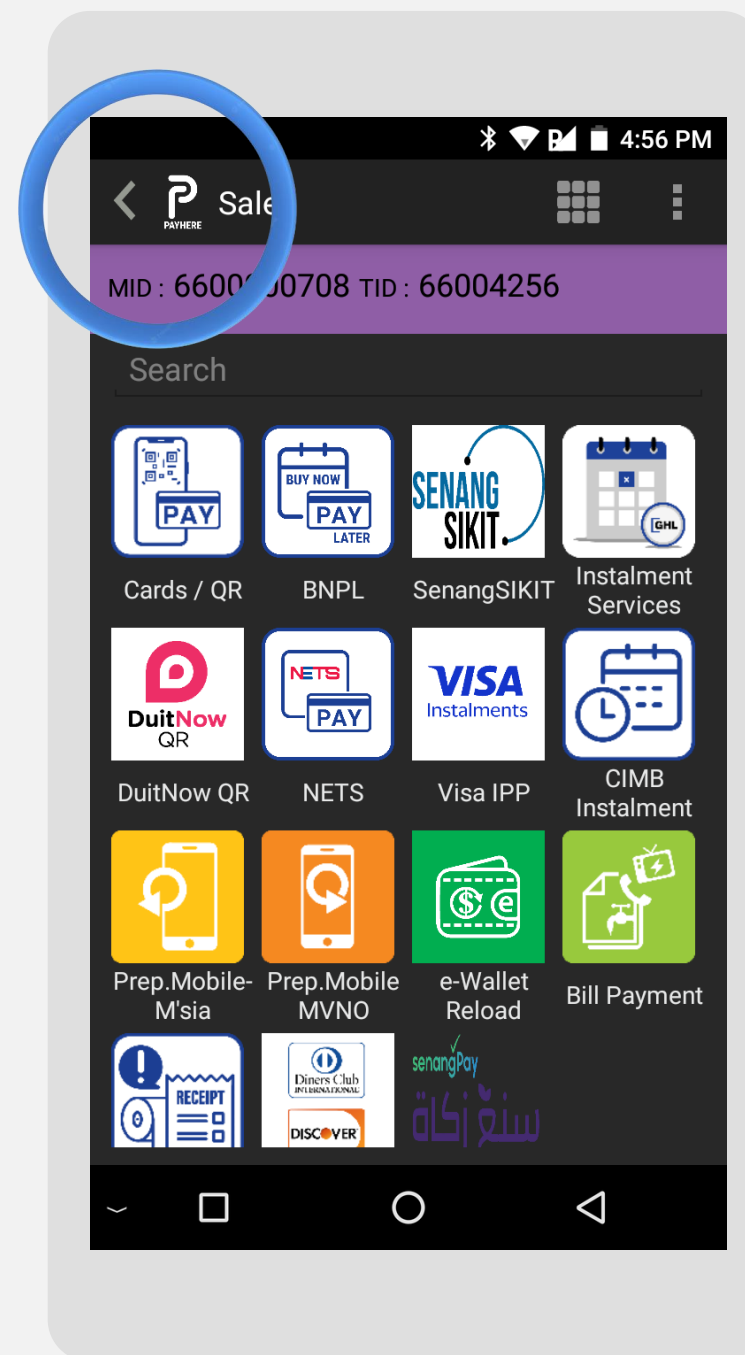

STEP
1

Press on < icon to open side menu

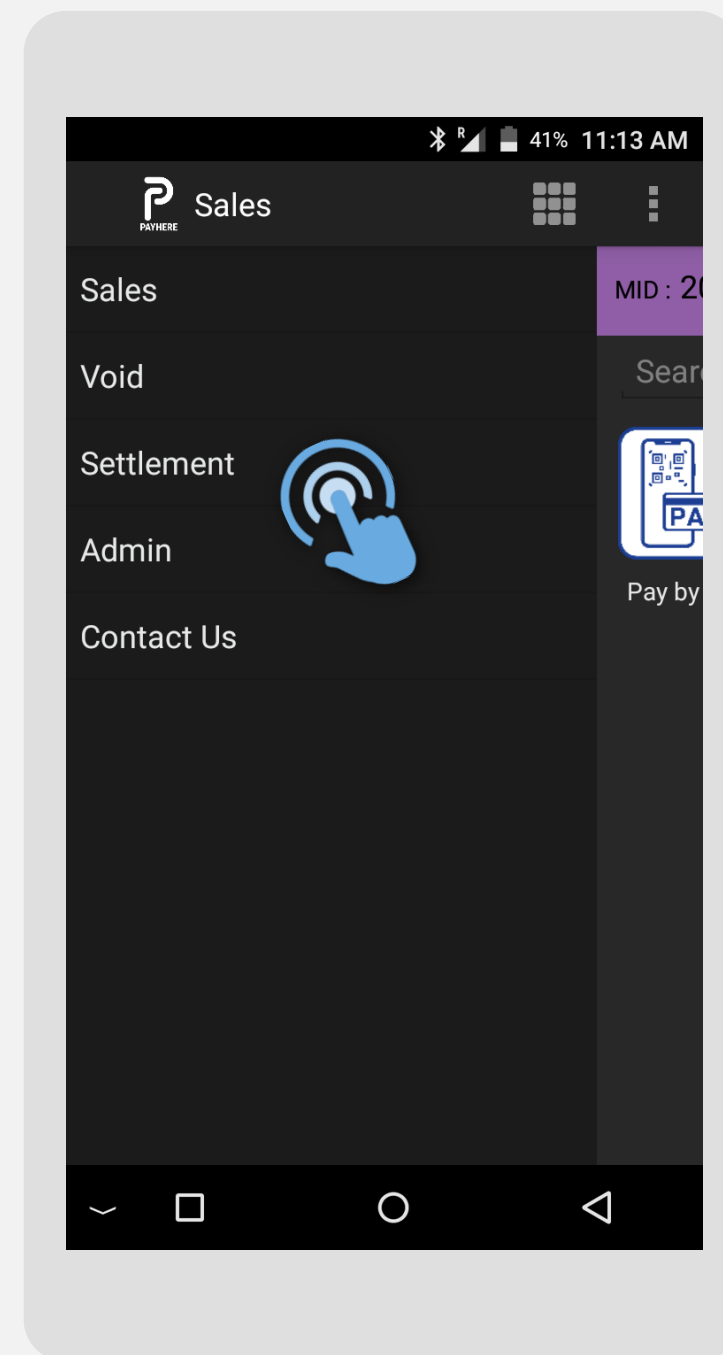

STEP
2

Press on **Settlement**

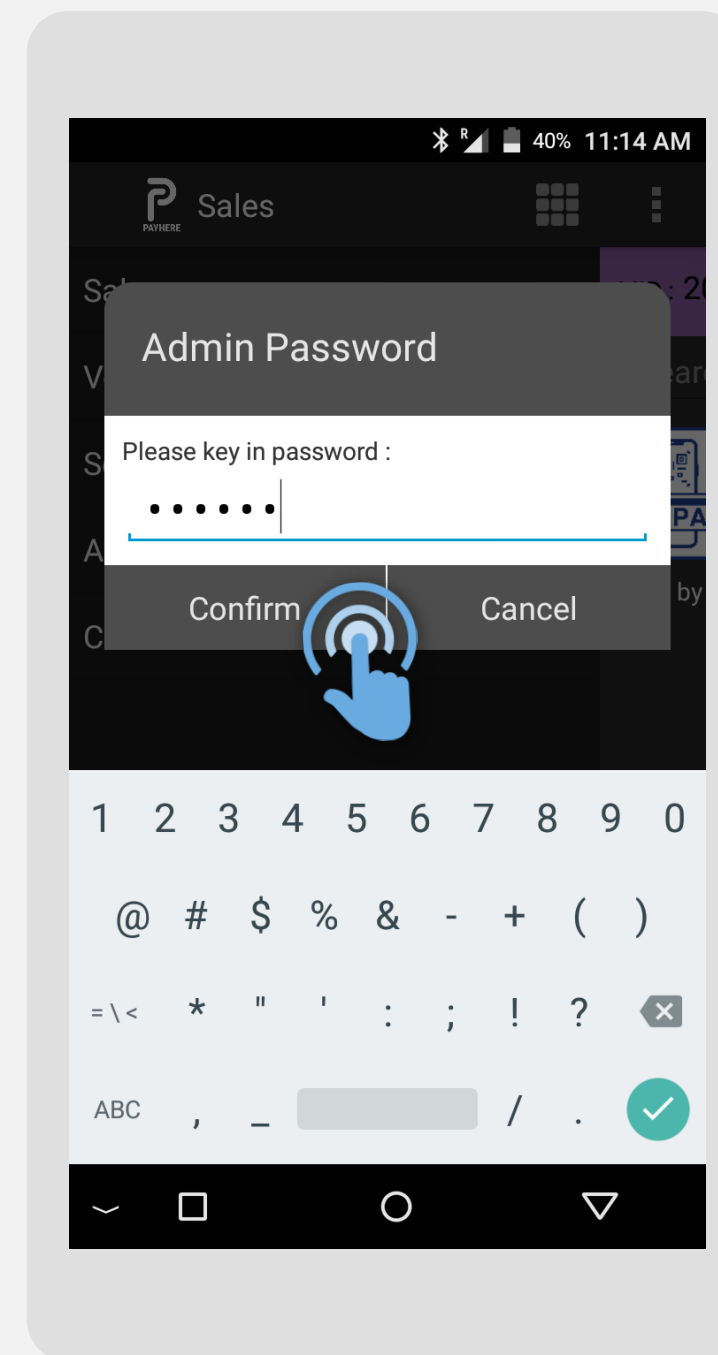

STEP
3

Key in Admin Password and press **Confirm**

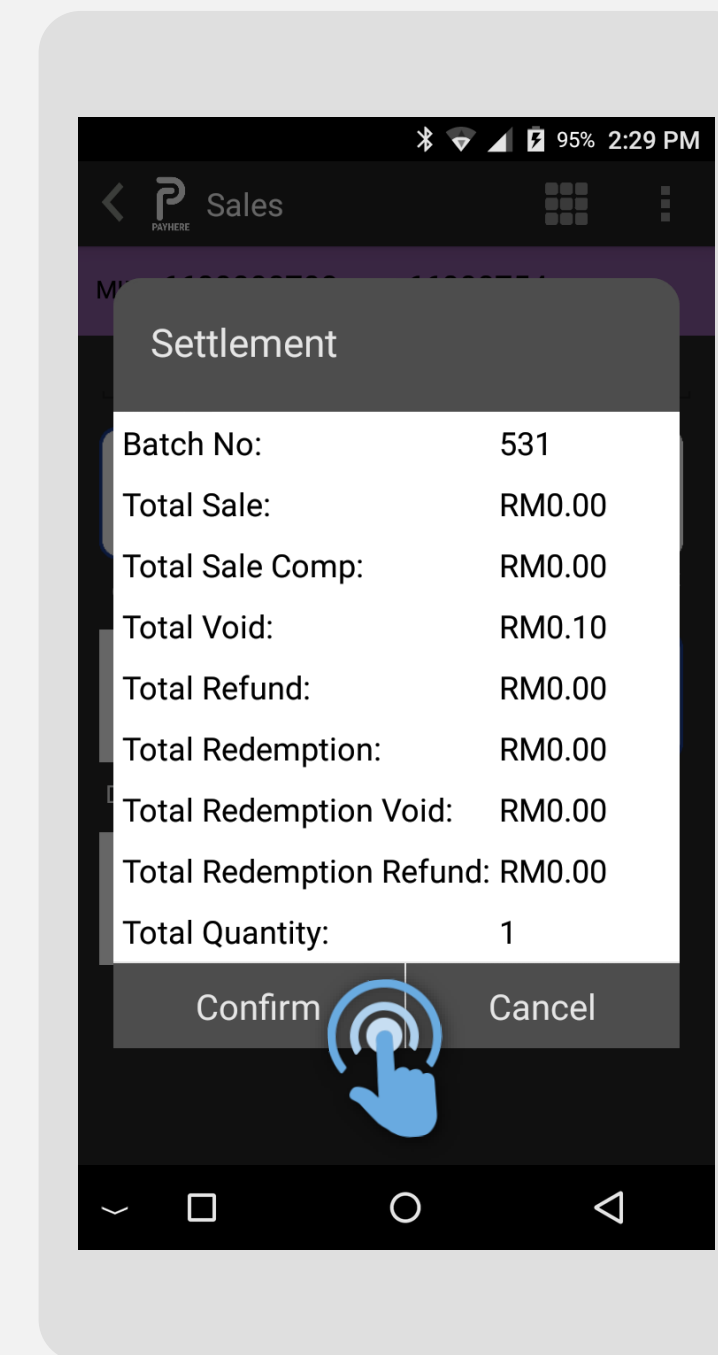

STEP
4

Press **Confirm** to proceed settlement

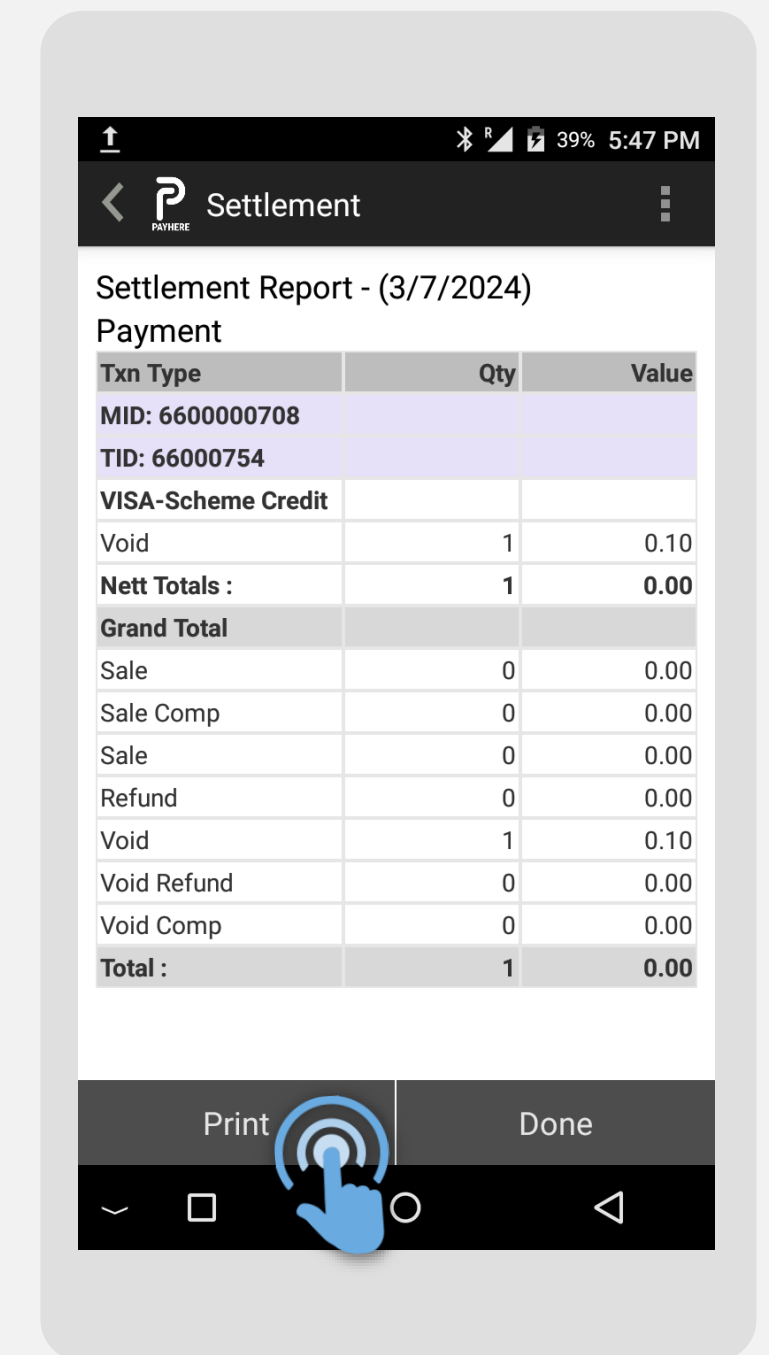

STEP
5

Press **Print** and process is successful with the settlement report receipt printed