



# TERMINAL USER GUIDE

Settlement

GHL MAH DA

Terminal Model: Android N5

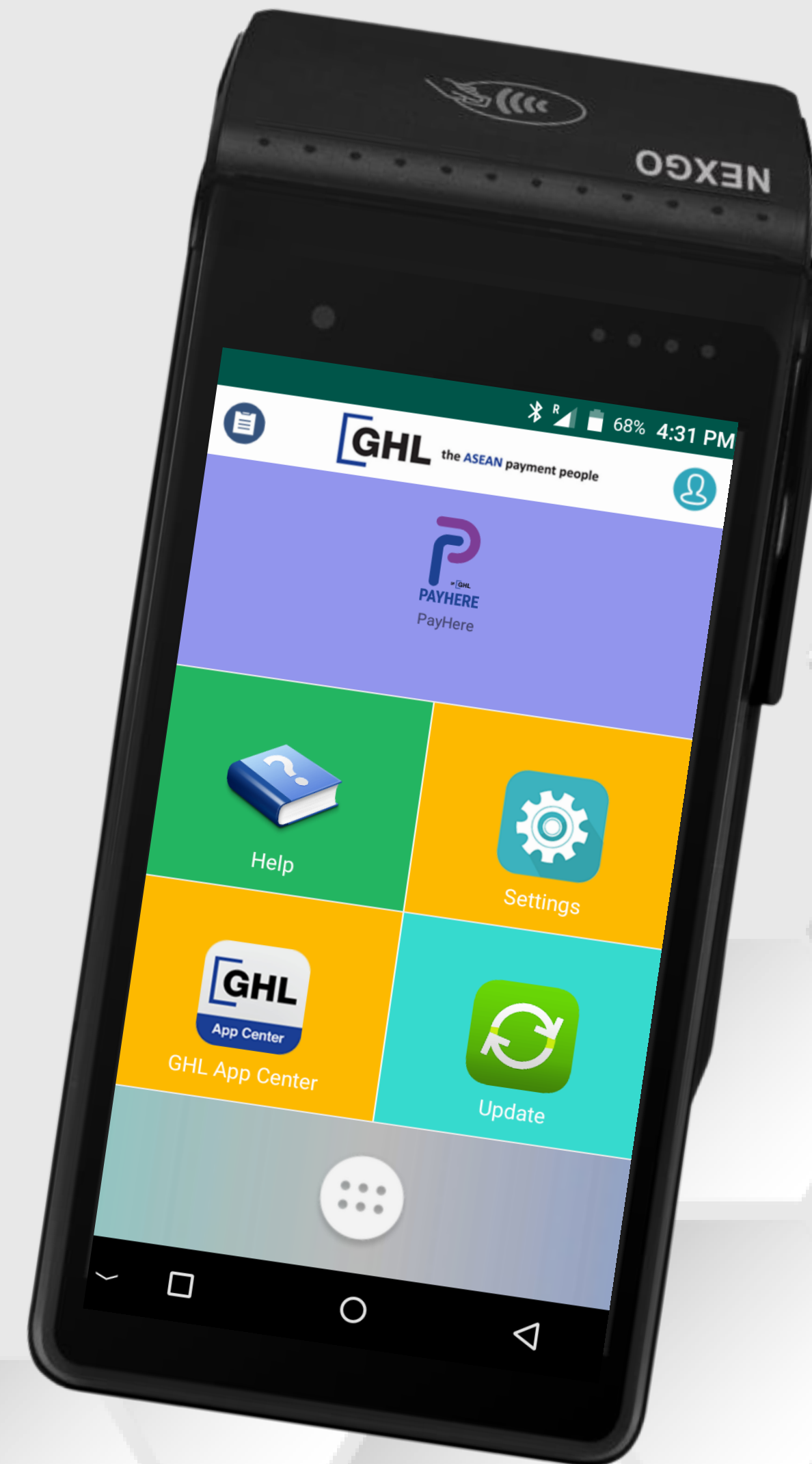

# Settlement

Terminal Model: Android N5

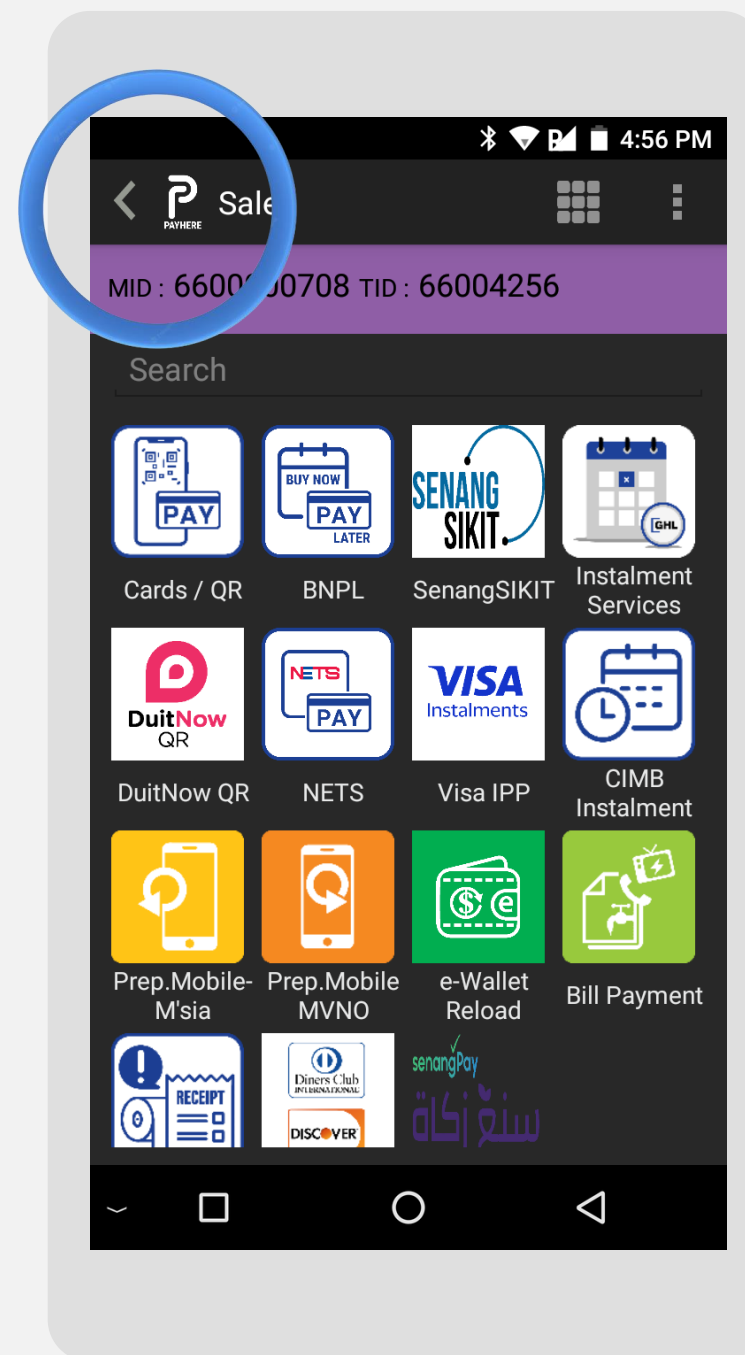

STEP  
**1**

Press on < icon to open side menu

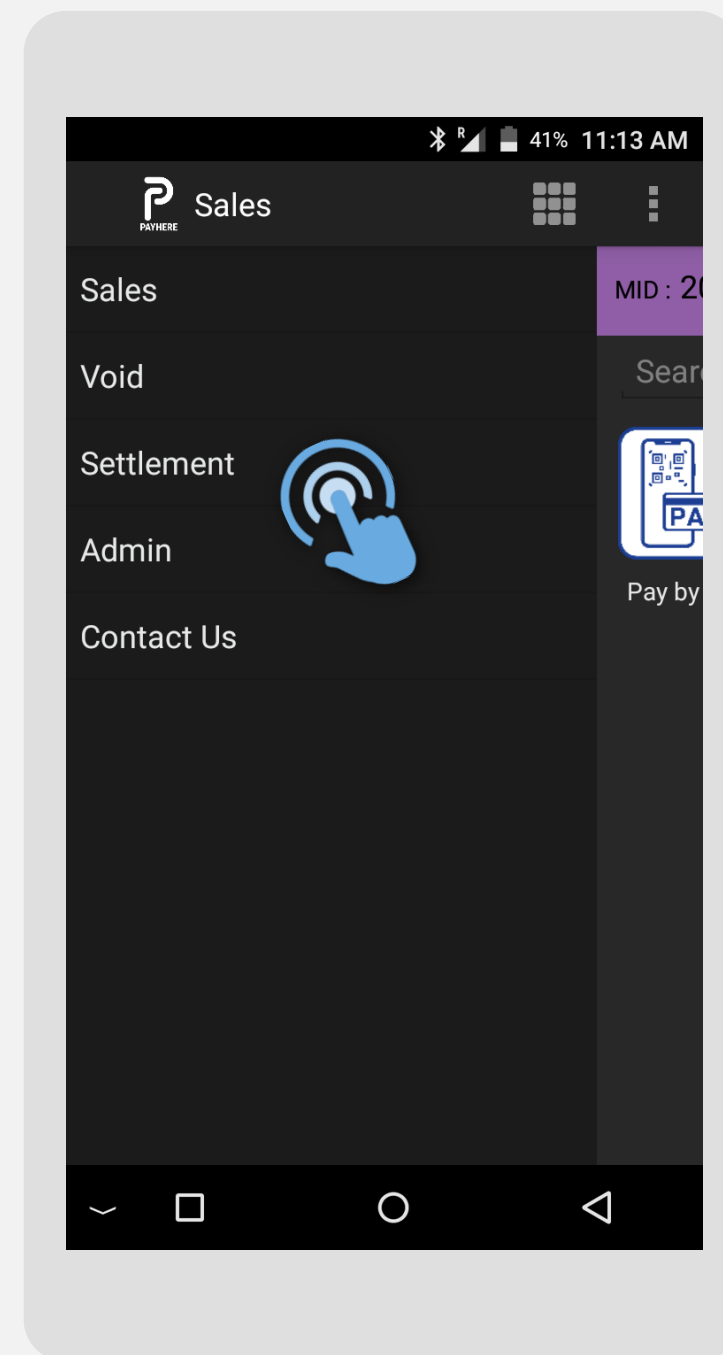

STEP  
**2**

Press on **Settlement**

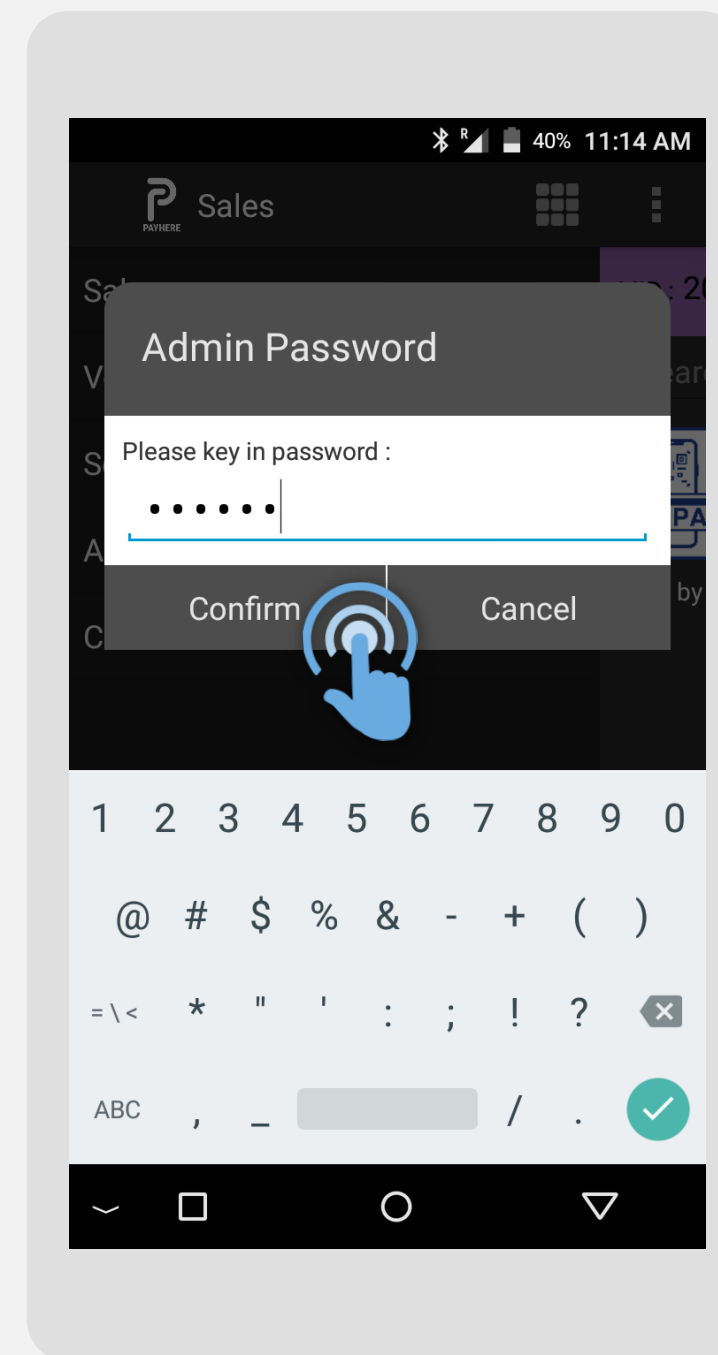

STEP  
**3**

Key in Admin Password and press **Confirm**

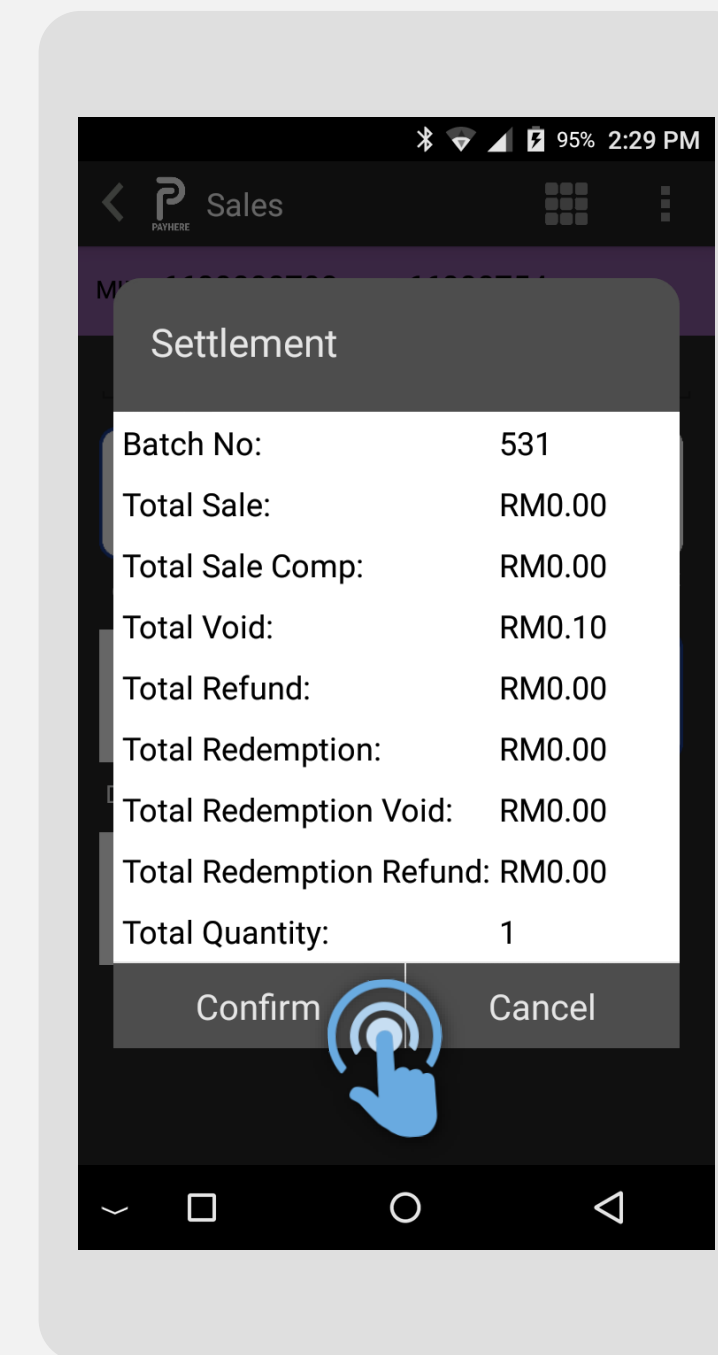

STEP  
**4**

Press **Confirm** to proceed settlement

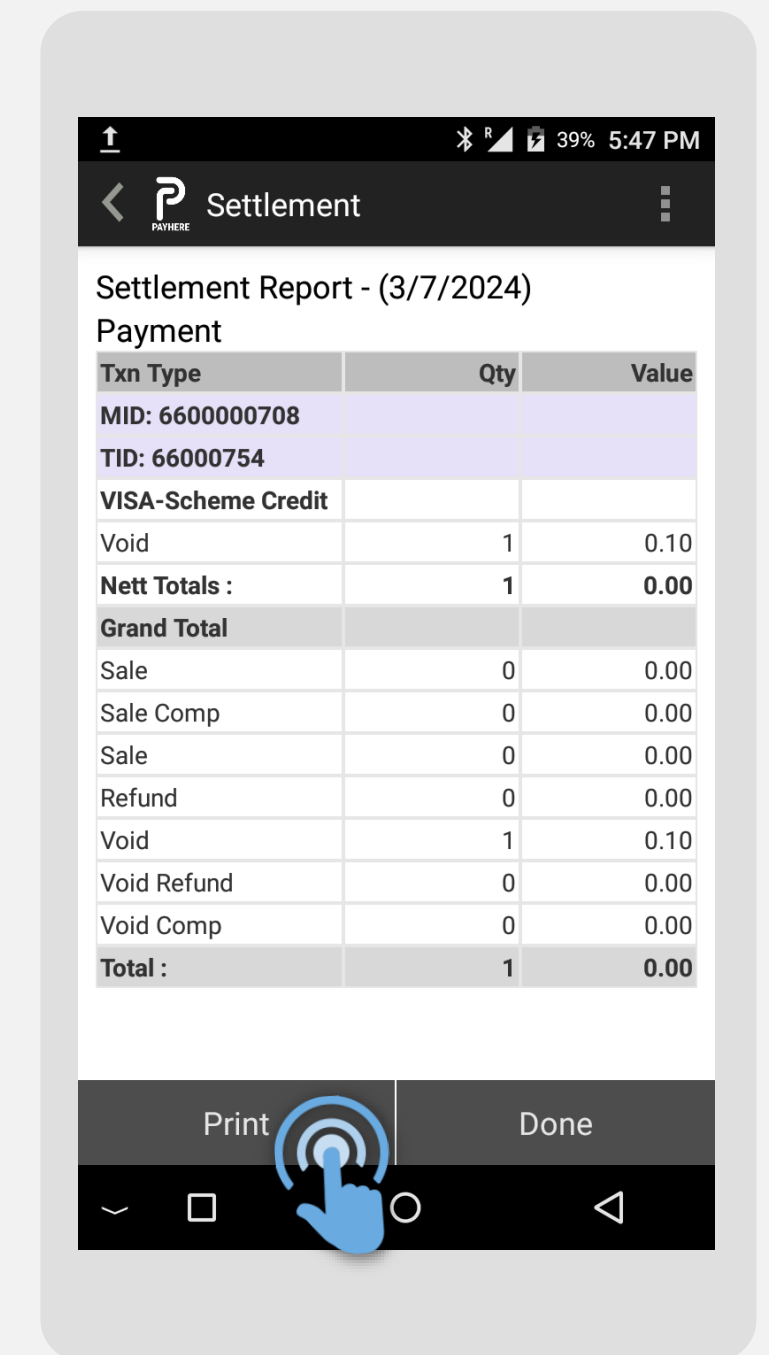

STEP  
**5**

Press **Print** and process is successful with the settlement report receipt printed